

PROPOSAL QUESTIONS/CONCERNS:

Order #: 9330 **Date:** May 3/18
Model #: BC1666-9330-C-1 **Wall Height:** _____
Dealer: Halston Homes **Hinge Height:** _____
Customer: Turner **Truss Spacing:** _____
of Proposals: 2



NOTE:

Please review all information and return responses through the Triple M Housing Sales Department.

Questions:

- 1.] Do you want the optional 31 1/4' buffet & hutch added to your order?
- 2.] Our standard exterior includes Craftsman accent boards on standard windows on hitch end and curbside (bottom of page). Do you want to switch the exterior accent to be on the hitch end and roadside (top of page)?
- 3.] Do you want to add optional Craftsman accent boards to any of the optional windows?
- 4.] Please sign & return floor plan so we can draw your elevations.

Dealer Responses:

(Provide DETAILED responses to ALL questions and list all changes/modifications to proposal here)

THIS DRAWING AND DESIGN IS COPYRIGHT PROTECTED AND SHALL NOT BE REPRODUCED IN WHOLE OR IN PART WITHOUT PRIOR WRITTEN AUTHORIZATION OF TRIPLE M HOUSING LTD.

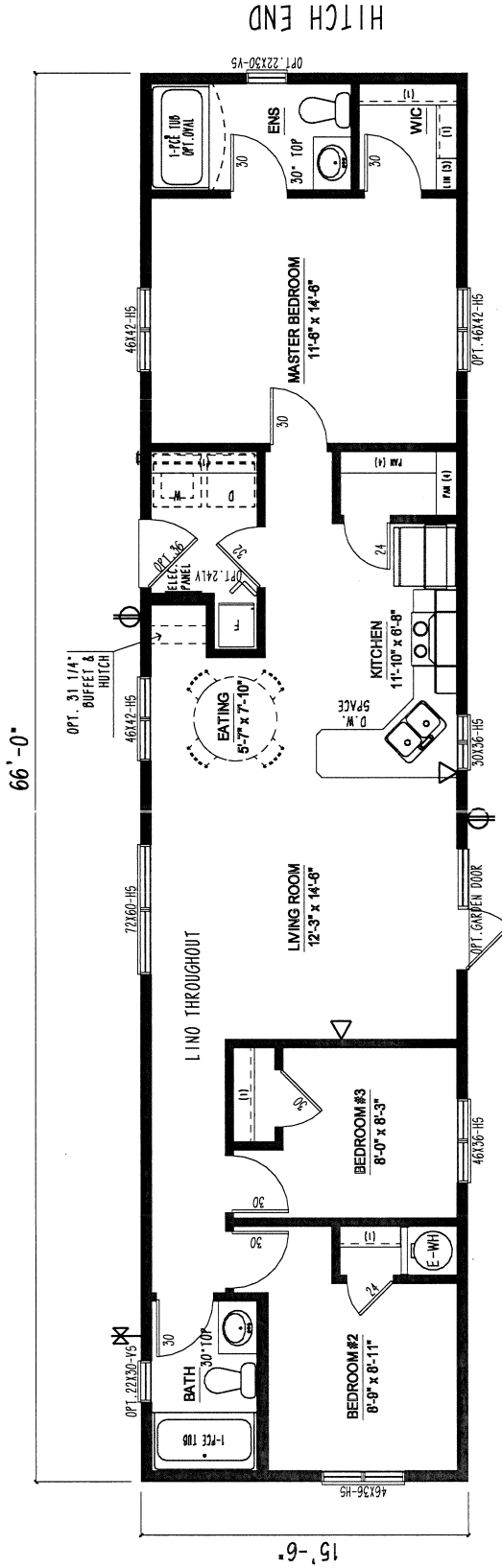

- ⊕ EXTERIOR G. F. I.
- FROST FREE TAP
- △ TVPHONE JACK

• REVIEW SIGNATURE & DATE •

• APPROVAL SIGNATURE & DATE •

• COPYRIGHT RESERVED

DEALER: HALSTON HOMES	CUSTOMER: TURNER	LETTERHEAD IS OWNED BY TRIPLE M HOUSING LTD. (403) 282-2000	REF. #1: 9330
SALESPERSON: GRAHAM KUSHNIRUK	DESTINATION: FALKLAND, B. C.	REF. #2: 2018-04-24	REF. #1: BC1666-9330-C-1
		REF. #3: 2018-05-03	TITLE: PROPOSAL DRAWING
		REF. #4:	